

# FLOOR SWITCH

Controller

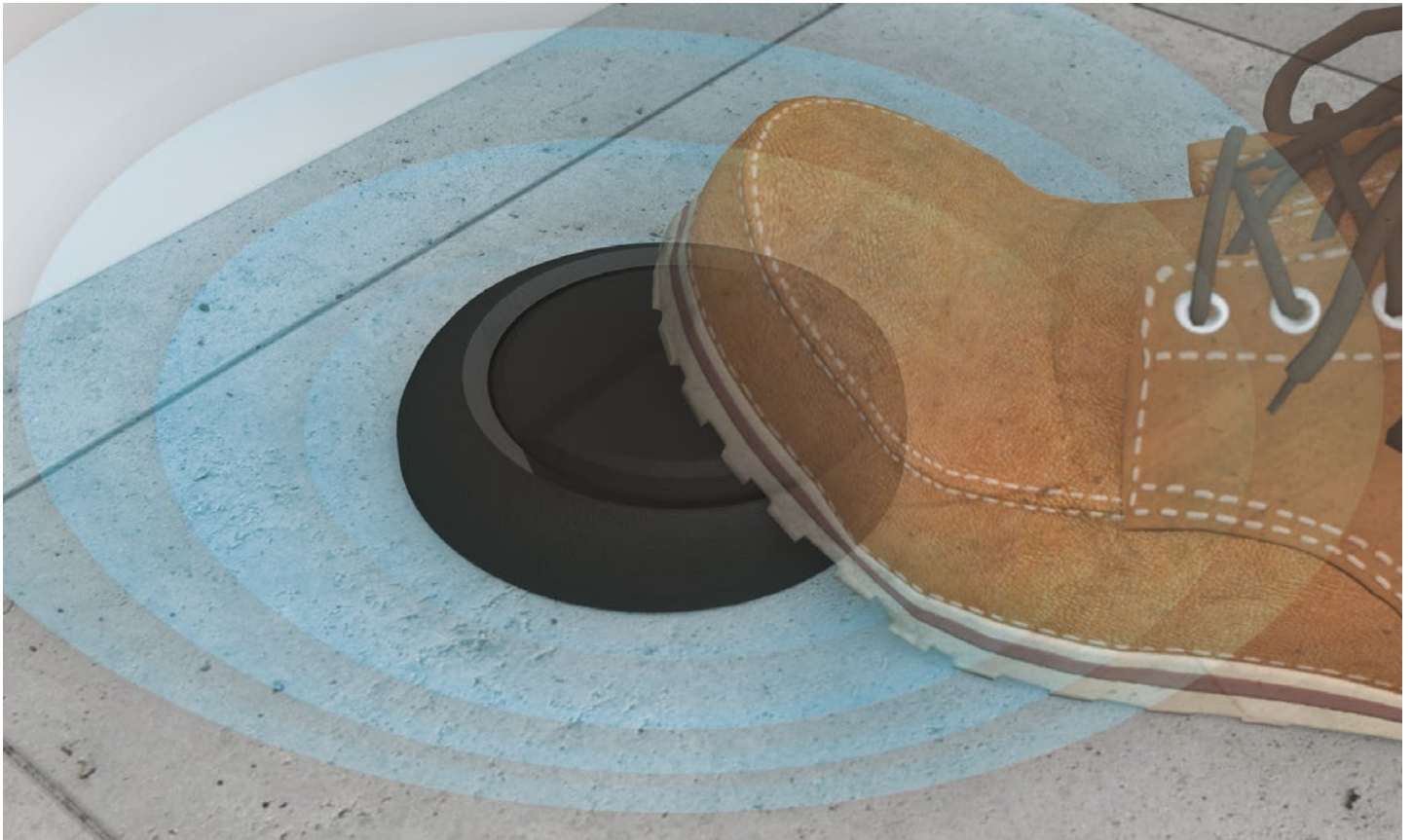

## Features

This switch allows to turn ON/OFF the light with the foot to ensure the health security of all. No more need to disinfect the switches and touch it, the Floor Switch is wireless, battery-less and to activate with the foot. It can be easily added and without any work to an existing installation thanks to an ON/OFF Lighting Module.



### NO CONTACT, NO DISINFECTION

The Floor Switch allows to avoid contacts that could help the spread of the virus. It allows to turn the light ON with the foot, to not regularly disinfect wall switches.



### WIRELESS: EASY AND WORK FREE INSTALLATION

The Floor Switch can be fixed with screws or adhesive tapes to the wall or on a baseboard. It is easy to pair to an ON/OFF Lighting Module (see wiring diagrams page 3).



### NO BATTERY: NO MAINTENANCE

The Floor Switch works thanks to the mechanical energy generated by the push on the button.



### RESISTANT TO CLEANING PRODUCTS

The Floor Switch is suitable for all types of locations and is resistant to cleaning products.



### SMART CONTROLLER

The Floor Switch works directly with EnOcean products.

## Technical specifications

**Power source:** Magneto-resistive (no battery)

**1 button - 1 channel**

**Floor mounting:** using adhesive bounding (included) or screws (not included)

**Radio frequency range:** 868.0 to 868.6 MHz

**Radio range:** up to 30m indoor

**EEP (EnOcean Profile):** F6-02-01

**Accessories included with the product:** 1 fast connector, 1 junction box cover, 1 sticker



# Ensure the security and health of your employees, customers, suppliers



Activate the light with the foot in workspace to protect the physical health of the employees



Installation in a school, against on a baseboard or on the floor, wireless and battery-less



Retrofit lighting without construction work in a medical practice: no wiring, fast installation of the wireless battery-less Floor Switch



Resistant to cleaning products, to humidity and adapted to all places



Ensure the elders health by minimizing physical contacts

## A complete radio plug and play solution

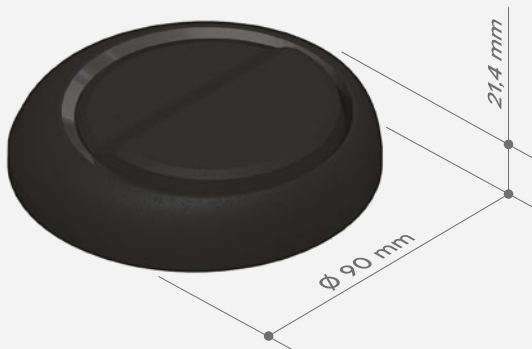

Floor Switch + ON/OFF Lighting Relay Switch firmware version V3.5.0



Designation	Reference / EAN
Floor Switch and ON/OFF Lighting Relay Switch firmware version V3.5.0	CFS-2-1-05 + SIN-2-2-01 / 3700313925096
Floor Switch	CFS-2-1-05 / 3700313925065

# Floor Switch installation example

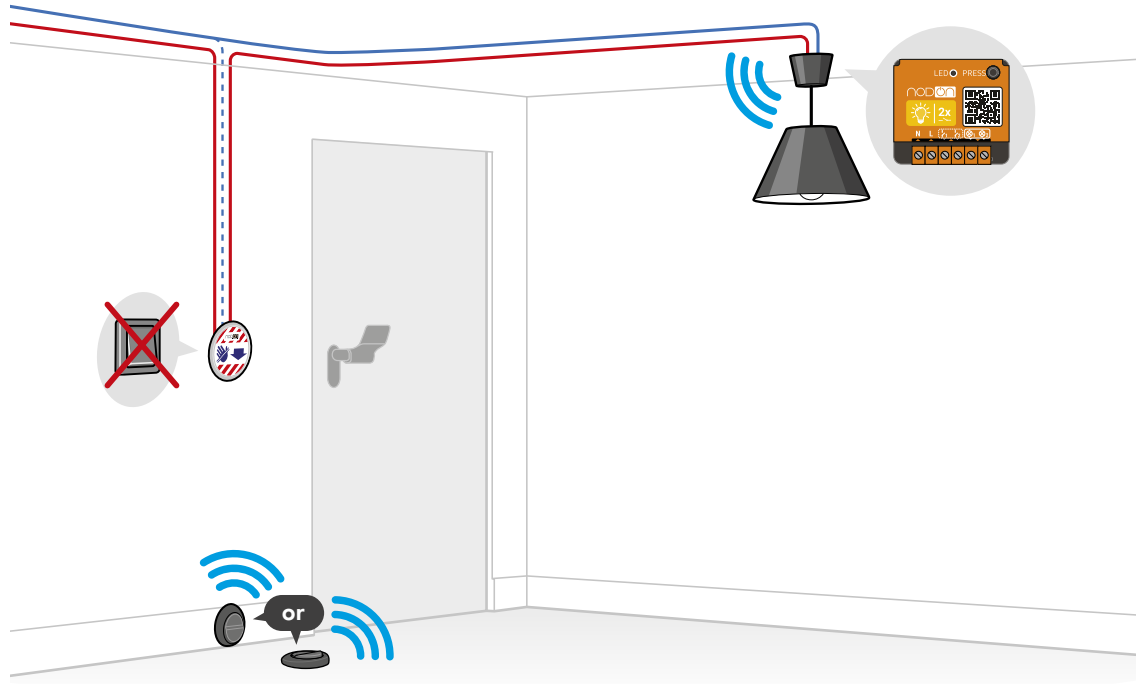

## Wiring diagram of the ON/OFF Lighting Relay Switch



- N** Terminal for the Neutral
- L** Terminal for the Line
- $\downarrow$  1/1 Input terminal for the wired switch 1
- $\downarrow$  1/2 Input terminal for the wired switch 2
- $\otimes$  1 Output 1 (controlled by  $\downarrow$  1/1)
- $\otimes$  2 Output 2 (controlled by  $\downarrow$  1/2)

**Note:** Each terminal can accept a cable of 2.5mm<sup>2</sup> maximum

### Wiring of the ON/OFF Lighting Relay Switch in the DIN Rail Box\*

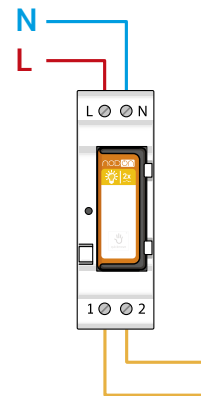

\*DIN Rail Box on the [nodon.fr](http://nodon.fr) website

### Before installation

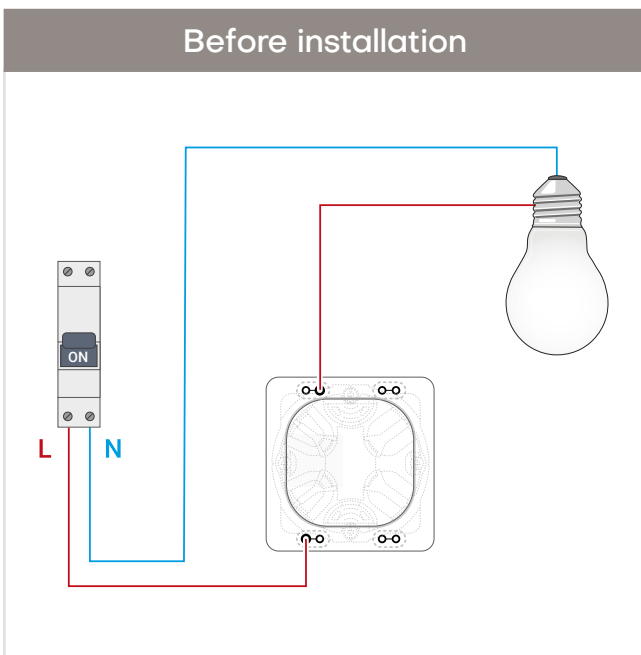

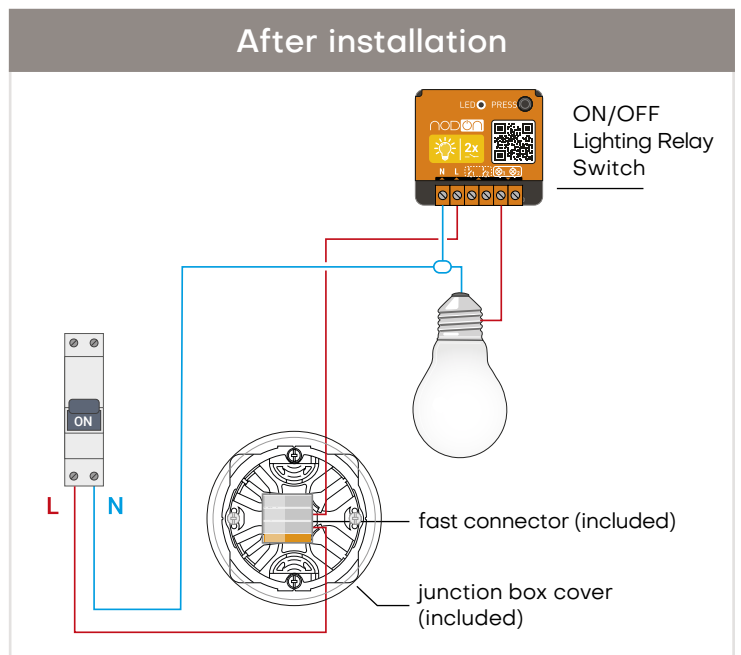

### After installation







# Lightings compatible with the ON/OFF Lighting Relay Switch









## Resistive loads

Light type		P. Max
	Incandescent light	1100W
	Halogen lamp 230V	1100W

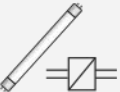
## Inductive loads

Light type		P. Max
	Neon with ferromagnetic ballast	 <i>Not compatible</i>
	Gas-discharge lamp / Metal halide lamp	 <i>Not compatible</i>

## Capacitive loads

Light type		P. Max
	Standard energy-saving lamp	80W
	Dimmer energy-saving lamp	80W
	Neon with electronic ballast	100W
	LED lamp 230V	500W
	Filament LED	90W
	LED lamp 12V with converter	80W
	HPS	 <i>Not compatible</i>

# Floor Switch installation and use

## DANGER OF ELECTROCUTION



BEFORE ANY INSTALLATION MAKE SURE THE POWER SUPPLY IS DISCONNECTED TO AVOID ANY RISK OF ELECTROCUTION.

Directly cut the power supply from the breaker box to avoid any risk of electrocution. This relay switch is designed to be used power up, a wrong installation can create a fire or an electric shock. If you are not confident about electrical installation, please ask a professional.

The relay switch must be installed and connected carefully following the instructions of this user guide. We will not be responsible for any loss or damage resulting from a non-respect of the instructions of this user guide. Cut the power supply before any operation and don't do any modification if the LED is still ON.

### 1. CUT THE POWER SUPPLY

### 2. DISMOUNT THE WIRED SWITCH

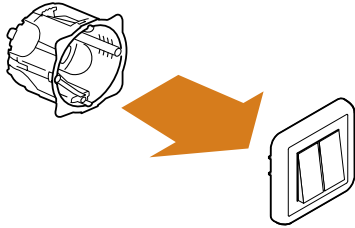

### 3. INSTALL THE FAST CONNECTOR INCLUDED

See diagram page 3.

### 4. INSTALL THE JUNCTION BOX COVER INCLUDED

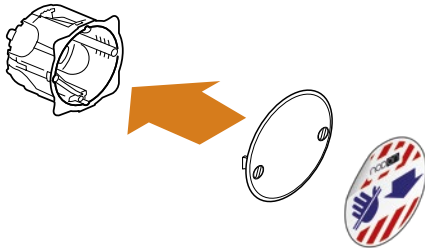

### 5. MOUNT THE ON/OFF LIGHTING RELAY SWITCH

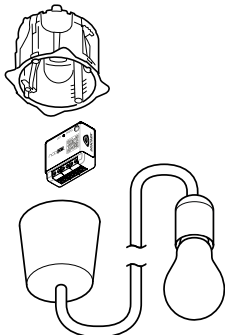

See diagram page 3.

### 6. TURN THE POWER BACK ON

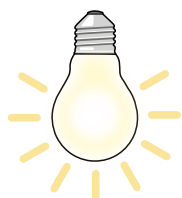

The lamp is ON.

## 7. PAIRING OF THE ON/OFF LIGHTING RELAY SWITCH

To add a Floor Switch, you must enter the pairing mode, your light must be switched OFF.

**Relay switch must be power.**

### CHANNEL 1 ( / )

From the relay switch

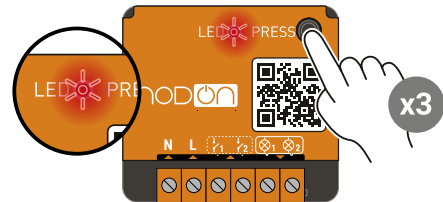

**7.1** Launch the pairing by doing 3 consecutive presses on the relay switch button. The LED blinks red.

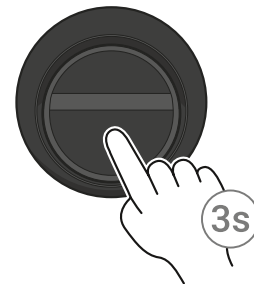

**7.2** You have 30 seconds to pair your Floor Switch by pressing the button for 3 seconds.

## 8. CLOSE THE CEILING JUNCTION BOX

## 9. INSTALL THE FLOOR SWITCH

Simple and fast installation with an adhesive bounding (included) or screws (not included), on the floor or on a baseboard:

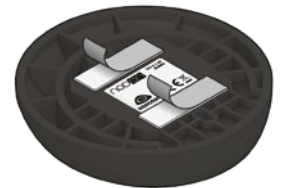

or

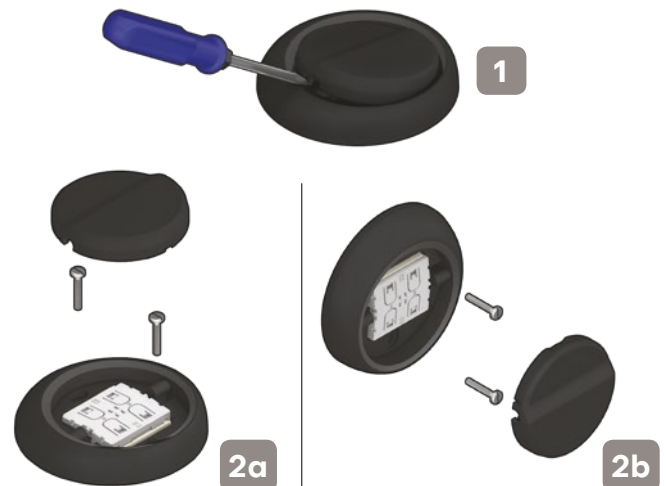

See examples of installation on page 3.