

ON/OFF LIGHTING RELAY SWITCH

nodon 

Actuator

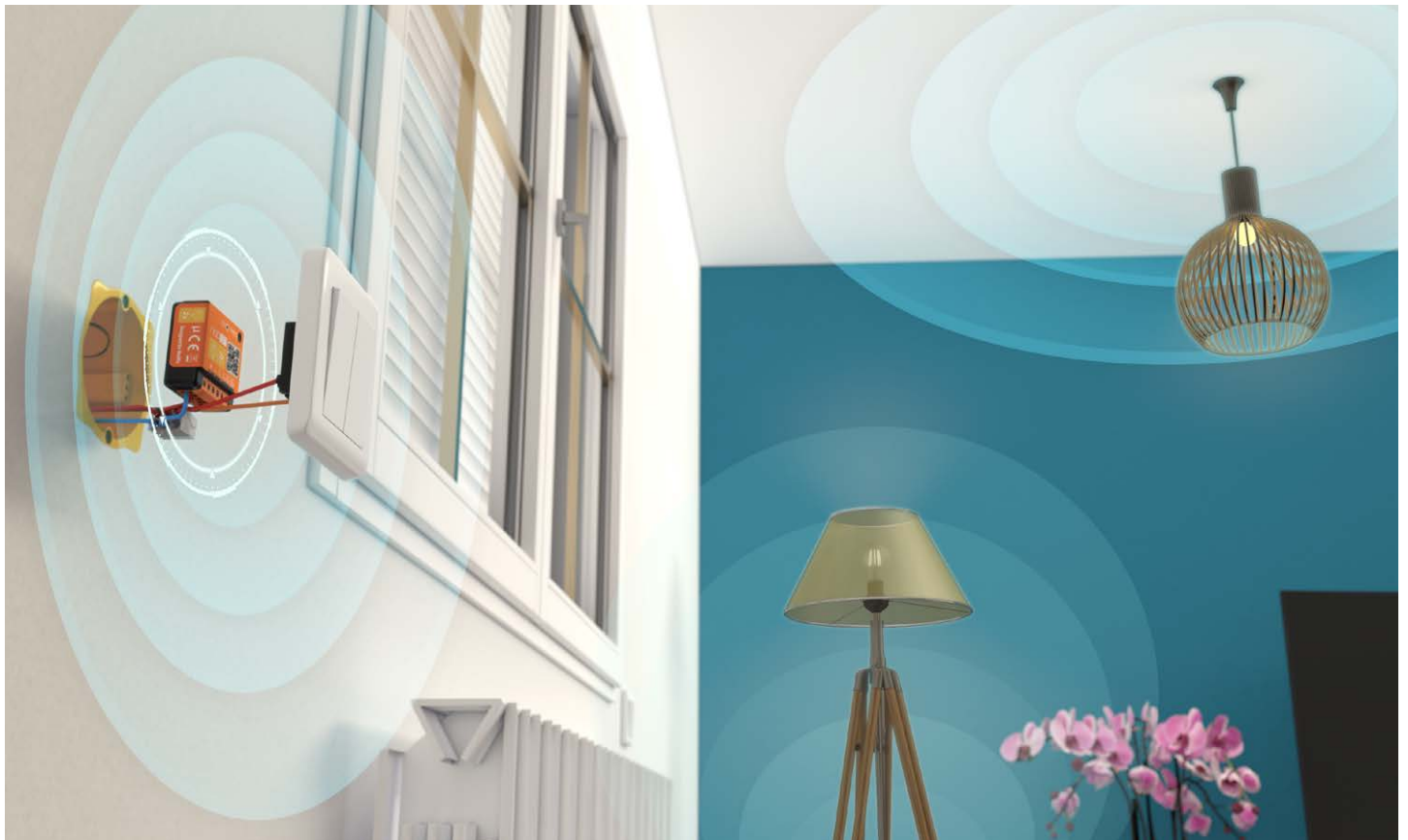

Features

With its two channels, the ON/OFF Lighting Relay Switch enables the user to connect and remotely control one or two lights with a wireless and battery-free controller (wall switch, remote, ...). It is easy to install, without building work, behind a wired wall switch, on the ceiling or in the electrical panel.



SIGNAL REPEATER

The relay switch repeats all messages from all others EnOcean devices



ULTRA LOW PROFILE

Installation in electrical boxes from >30mm



INSTALLATION AT THE ELECTRICAL PANEL

DIN Rail Box*** needed



REMOTE COMMISSIONING

Wireless installation without physical intervention

Technical specifications

Power supply: 230V AC ~ 50Hz

Switching capabilities: 230V AC - 2 x 5A

Consumption: <1W

Maximum output power: 2 x 1.150W (resistive load)

See page 7 - List of compatible loads available on www.nodon.fr/loads

Radio frequency range: 868.0 to 868.6 MHz

RF power max: +3dBm

Range: up to 30m indoors

Operational temperature: -10°C to 40°C

Protection rating: IP 30

Pairing: up to 22 controllers

EEP (EnOcean Profile): D2-01-12



List of compatible home automation gateways available on www.nodon.fr

Renovation



Creation of a new back-and-forth with a wireless and battery-less wall switch



Redesigning hassle free: individual lighting control



Automatic or remote control of room lights

Serenity



Presence simulation: automatically turn the lights ON/OFF*

Comfort



Central and smart management of lighting thanks to motion detection

*Home automation gateway needed

Installation



- N** Terminal for the Neutral
- L** Terminal for the Line
- ↓/1** Input terminal for the wired switch 1**
- ↓/2** Input terminal for the wired switch 2**
- ⊗1** Output 1 (controlled by ↓/1)
- ⊗2** Output 2 (controlled by ↓/2)

Note: Each terminal can accept a cable of 2.5mm² maximum

**Wired switch optional (see the installation diagrams section on the next page)

Wiring of the ON/OFF Lighting Relay Switch in the DIN Rail Box***



***DIN Rail Box page 18

Dimensions

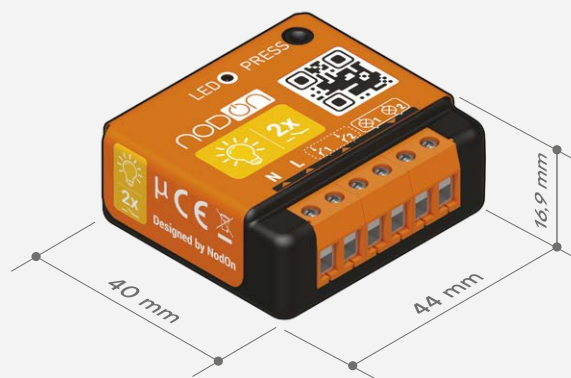

Reference

SIN-2-2-XX - EAN: 3700313921371

ON/OFF Lighting Relay Switch wiring diagrams

For two lights with a double wired switch

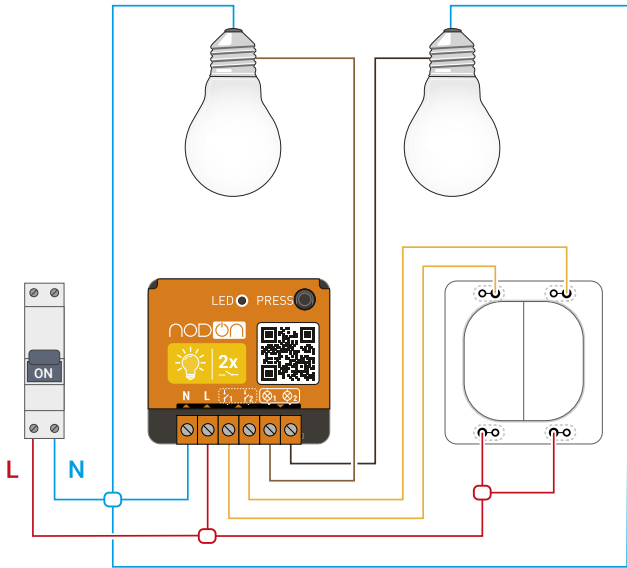

For one light with a single wired switch

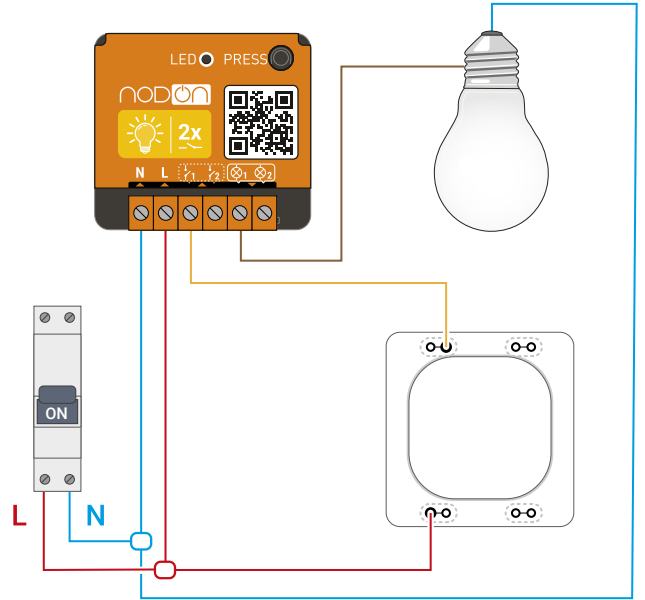

Without wired switch

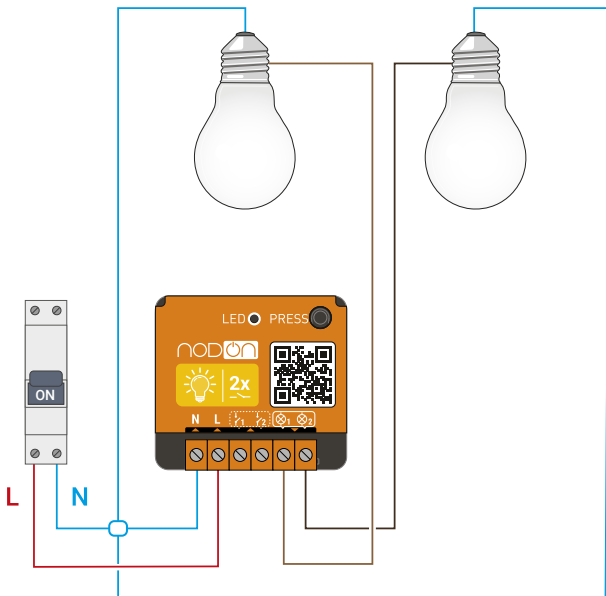

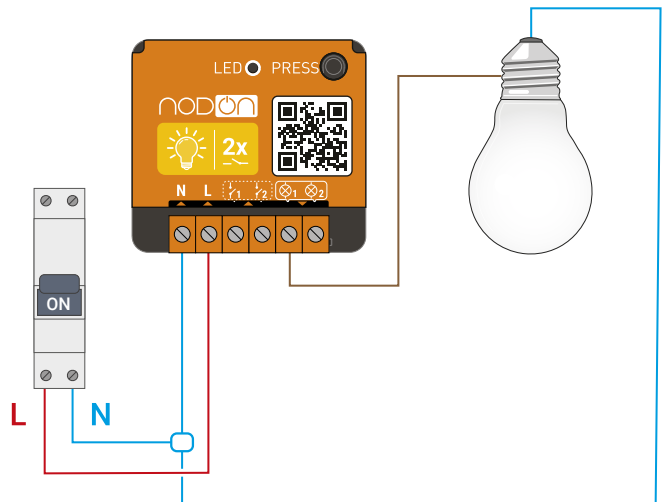

On the ceiling







Lightings compatible with the ON/OFF Lighting Relay Switch







Resistive loads

Light type		P. Max
	Incandescent light	1100W
	Halogen lamp 230V	1100W

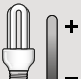
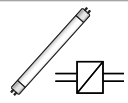
Inductive loads

Light type		P. Max
	Neon with ferromagnetic ballast	 <i>Not compatible</i>
	Gas-discharge lamp / Metal halide lamp	 <i>Not compatible</i>

Capacitive loads

Light type		P. Max
	Standard energy-saving lamp	80W
	Dimmer energy-saving lamp	80W
	Neon with electronic ballast	100W
	LED lamp 230V	500W
	Filament LED	90W
	LED lamp 12V with converter	80W
	HPS	 <i>Not compatible</i>